

# Junction box

Type: AU19

GTIN: 6410011521199



The AU19 junction box has knock-outs for 8 inlets and 4 bottom inlets. The box can be fastened using side nailing or a PMR577 support. The box has four screw pillars, two for M4 screws and two for 3,5mm universal screws. The box is possible to install in cramped spaces. The depth, 47 mm, is the same as the depth of the mounting boxes. Made of halogen free material (IEC/61249-2-21) and fulfills the requirements of the glow wire test according to the standard IEC/EN60670: 2005 (850 °C). Max amount of conductors 30pcs.

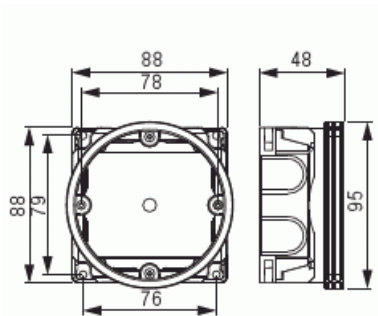

## Technical specification

### General Information

Product ID:	2TKA130027G1
-------------	--------------

### Packing

Package:	100
Unit:	PCS

### ETIM Data

Mounting method:	Flush mounted (plaster)
Shape:	Round
Construction type:	Cable junction box
Model:	Single



Provided with revolving ring:	No
Connectable:	Yes
Equipped with:	None
Diameter:	94 mm
Length:	88 mm
Width:	88 mm
Depth:	88 mm
Inner depth:	45 mm
For number of electric fittings:	1
Mounting switching equipment:	Screwing
With screws:	Yes
Housing feed-through by break-out opening:	No
Housing feed-through by seal membrane:	No
Housing feed-through by nozzle:	No
Housing feed-through by step membrane:	No
For tube diameter:	20/25 mm
Pipe locking:	Yes
Pipe locking optional:	No
Inlet from the rear:	Yes
Material:	Plastic
Halogen free:	Yes
Surface protection:	Untreated
Colour:	White
Transparent cover:	No
Cover attachment:	Snapped on
Sealable:	No
With screening:	No
Air tight:	No
Clamp position fixed:	No
Luminaire hook mounting:	No
Special application:	None